

LAUNCHING

WORLD

of

LUXURY • LIFESTYLE • AMENITIES

 FOREST
Sunteck World
VASIND, DIST. THANE



Retail and High Street



MIXED USE TOWNSHIP



GRAND CLUBHOUSE



**MULTIPURPOSE
SPORTS ARENA**



AMPHITHEATRE



WATER RESERVE



RESTAURANTS



SAFETY & SECURITY



Live The Extraordinary

A city within a city, this luxurious township offers comfort and lifestyle that matches your way of life. This is a home that overlooks nature's finest work laid out all for you.

40 ACRES approx.
Township Living

30+ ACRES
Green & Open Spaces

17 STOREYS
Tallest Towers
in the Vicinity

6 APARTMENTS
Per Floor

1 & 2 BHK
Luxury Residences



Township Living



ARTIST'S IMPRESSION



REFERENCE IMAGE

INDOOR GAMES



REFERENCE IMAGE

SWIMMING POOL



REFERENCE IMAGE

GYMNASIUM



REFERENCE IMAGE

MEDITATION/YOGA ZONE



REFERENCE IMAGE

JOGGING TRACK

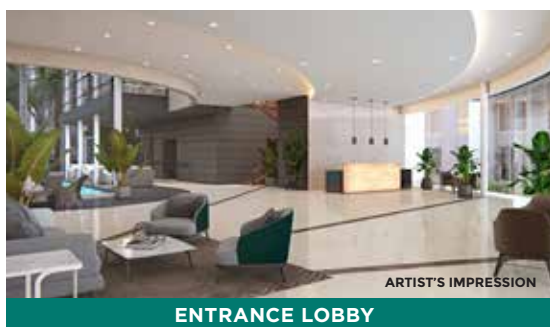

ARTIST'S IMPRESSION

ENTRANCE LOBBY



REFERENCE IMAGE

MULTIPURPOSE HALL



REFERENCE IMAGE

PARTY LAWN

- CRICKET PRACTICE PITCH
- SENIOR CITIZEN'S ZONE
- BADMINTON COURT
- ZUMBA/AEROBICS ZONE
- SKATING RINK
- WATERSIDE WALK
- LANDSCAPED GARDEN
- BASKETBALL COURT
- KID'S LAWN & MANY MORE...





Excellent Social Infrastructure



Showing prominent locations on Central Line (fast)

Map not to scale

AVAILABLE WITHIN 20 MINUTES DISTANCE

- | | | |
|--|--|---|
| <p> FOOD AND BEVERAGES</p> <ul style="list-style-type: none"> • STARBUCKS • BHAGAT TARACHAND • KAILASH PARBAT • FOODMAX RESTAURANT • MANY MORE F&B ALONG THE HIGHWAY | <p> SHOPPING CENTRES</p> <ul style="list-style-type: none"> • OASIS SHOPPING CENTRE <p> CORPORATES</p> <ul style="list-style-type: none"> • JSW STEEL LTD • AMAZON • GODREJ • MYNTRA • DMART • MAHINDRA • RELIANCE | <p> EDUCATIONAL INSTITUTES</p> <ul style="list-style-type: none"> • NEW IDEAL SCHOOL AND JR. COLLEGE • KIDZEE PRE PRIMARY SCHOOL • Z.P PRIMARY SCHOOL • M.B.D. ENGLISH MEDIUM SCHOOL • SHIVAJIRAO S JONDHLE KNOWLEDGE CITY • JINDAL VIDYA MANDIR |
| <p> HOSPITALS</p> <ul style="list-style-type: none"> • SANT GADGE MAHARAJ HOSPITAL • BALAJI HEALTHCARE • ACHARYA TAI HOSPITAL | | |



LOCATION & CONNECTIVITY

10-15 MINS. WALK
FROM VASIND RAILWAY STATION

5 STATIONS
FROM KALYAN

TOUCHING
MUMBAI NASHIK HIGHWAY (NH3)

UPCOMING

LINK ROAD

SAMRUDDHI MAHAMARG

- Sunteck is the **fastest growing** Mumbai-based real estate development company.
- It is amongst the **top 5 listed real estate** companies on NSE and BSE.
- Sunteck holds one of the **strongest balance sheets** with almost **negligible debt** levels and visible cash flows.
- It focuses on a city-centric development portfolio of about **38 million square feet** spread across **19 projects**.
- It's presence across the spectrum is **differentiated** by Uber Luxury, Ultra Luxury, Premium Luxury & Aspirational Luxury segments.
- Sunteck's **flagship project Signature Island** in Bandra-Kurla Complex (BKC) is home to some of the most renowned head honchos of leading financial institutions, corporates, global conglomerates and renowned celebrities.



SUNTECKCITY, ODC, GOREGAON (W)

RERA NO: P51800001281 | P51800002637
P518000023072



SUNTECKWORLD, NAIGAON (W)

RERA NO: P99000017606 | P99000017627 | P99000024072 | P99000024080
P99000024111 | P99000024173 | P99000027956



SIGNIA WATERFRONT, AIROLI

RERA NO: P51700011528

Site Address: Sunteck Forestworld, Vasind, Dist. Thane, Maharashtra - 421601

Corporate Office: Sunteck Centre, 5TH Floor, 37 - 40 Subhash Road, Vile Parle (E), Mumbai - 400057

Sunteck

022 5064 5695 | www.sunteckforestworld.com

MAHARERA NO: P51700030578 | P51700030580 | P51700030607. Details Available At <https://maharera.mahaonline.gov.in>

Disclaimer: The project "Sunteck FORESTWorld" ("Project") is being developed by Sunteck Realty Holdings Private Limited. ("Promoter"). The photographs, images, pictures, visuals used are stock photography. All photographs are for illustrative purposes only. The specifications and other details herein are merely an Architect impression of the Project. The Specifications, amenities, and facilities will be as set out in the agreement for sale as uploaded on the RERA website (<https://maharera.mahaonline.gov.in>) under Registration No. P51700030578, P51700030580, P51700030607. The plans and the location of the amenities may be subject to modification/change/revision/alteration in terms of approvals, orders, directions and/or regulations of the concerned/competent authorities, and/or for compliance with laws/regulations in force from time to time. The common areas and common amenities for the entire layout shall be made available for the entire project and will be completed and handed over after completion of the development of the entire layout. The modification/alteration will be by following due procedure as prescribed under the Real Estate (Regulation and Development) Act, 2016, ("RERA") read with the provisions of the Maharashtra Real Estate (Regulation and Development) (Registration of real estate agents, rates of interest and disclosures on website) Rules, 2017 and the Rules and Regulations framed under RERA for Maharashtra ("RERA Rules") and the relevant applicable disclosures shall be made at an appropriate time. This electronic / printed material does not constitute an offer and/or contract of any type between the Promoter and the recipient. No booking or allotment shall be deemed to have been made on the basis of this electronic / printed material. *Terms & Conditions Apply. Offer subject to loan eligibility of the customer. The above offer/scheme is at the sole discretion of the developer and is subject to change/alteration/modification/withdrawal without any prior notice. The Landowners have mortgaged their entitlement and Land under the Joint Development with Sunteck Finance Limited.